

Panorama

Facts // News // Information

• Review 2017

In the last **"Panorama"** of this year, the editorial team is looking back on topics that had been the focus of **EMM-Check's** further development over the past few months.

One of the most important topics was the implementation of the standard "ISO 5006:2017". The standard urgently expected by all earthmoving manufacturers required some coordination meetings with users and testing organizations. REKNOW will provide an update immediately after the final clarification of the open questions for the manufacturers of excavators.

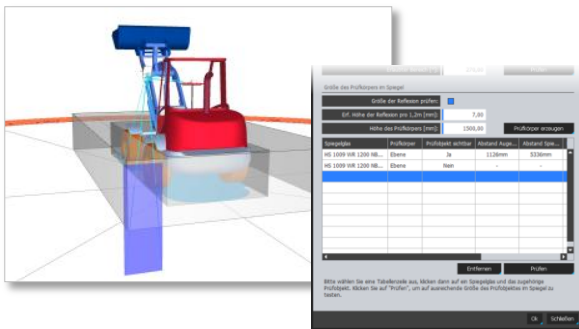

Another standard, which is still in the final stages of clarification, was also released in this year's **EMM-Check**. This is EN 16842, which, after its finalization, will replace the DIN EN 16307 standard currently applicable to European manufacturers of industrial trucks. With the early availability of the standard, manufacturers were able to gain initial experience with a new evaluation procedure using **EMM-Check**.

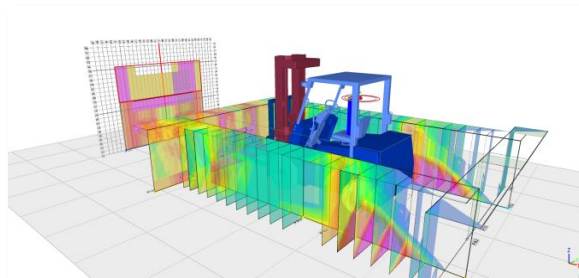

Another important topic was the expansion of virtual reality functionalities in **EMM-Check**. This year, REKNOW build the base for this with the implementation of the new, more powerful viewer, which delivers best performance with excellent display quality (e. g. smoothed surfaces, smooth transitions, material catalog) even with large amounts of data.

With the support of HTC Vive®, the base for providing a cost-effective VR solution for design reviews, product presentations and trainings was created. The "VR Cluster" add-on now enables this to be done across locations and in a team with several VR devices (Head Mounted Displays).



This year, REKNOW was represented with **EMM-Check** at several important events such as ElmiaWood in Sweden for the first time and again at Agritechnica and, of course, our 4th **EMM-Check** Customer's Day, which took place for the first time this year centrally in Frankfurt am Main and once again attracted the participation of leading companies in earthmoving machinery, agricultural machinery and industrial trucks.



REKNOW GmbH & Co. KG
Neumünstersche Straße 14
20251 Hamburg
Germany

REKNOW Verwaltungs GmbH
Neumünstersche Straße 14
20251 Hamburg
Germany

fon : +49(0) 40 / 98 76 00 02
fax : +49(0) 40 / 98 76 00 04
eMail : info@reknow.de
Internet: www.reknow.de

Kreissparkasse Walsrode
BLZ : 251 523 75
Kto-Nr. : 1094671
IBAN : DE35 2515 2375 0001 0946 71
SWIFT-BIC: NOLADE21WAL

Registergericht:
Hamburg
HRA: 114880

Registergericht:
Hamburg
HRB: 123110

Geschäftsführer:
Dipl.-Ing. (FH) Dirk Janßen
Dipl.-Ing. Sebastian Schneider

Steuernummer: 49/654/00864
Ust-ID-Nr. : DE 259 307 098

2017 was also an exciting year for REKNOW itself. In this way, we were able to move into an additional office in Hamburg location and thus build the base for further growth.

We were able to enter into further partnerships with leading component suppliers, such as Vetter Umformtechnik GmbH (forks), whose products we will implement in **EMM-Check** and provide them for the visibility field analysis.

The commissioning by other international companies this year strengthens the worldwide distribution of our software product and underlines our claim to establish **EMM-Check** as a standard tool for visibility field analysis on virtual commercial vehicles.

Last but not least, we are pleased to welcome Mrs. Michelle Mitsching to our team. Mrs. Mitsching has been working for our company since December 1st and will work as a sales and marketing assistant to advance the further internationalization of **EMM-Check**. We wish Mrs. Mitsching every success.



• Preview 2018

In addition to the implementation of further standards such as e. g. the ANSI/ITSDF B56.11.6-2013 (industrial trucks) for the year 2018 various functional extensions in the packages and add-ons are on the agenda.

A further functionality of the "Analysis Extended Package" will be the ability to integrate user-defined forks (comparable to the user-defined mirrors). A wizard supports the user importing the fork geometry and in defining the area on the upper side of the fork to be evaluated in the field-of-view standards (e. g. DIN EN 15830, ISO 13564).

At Agritechnica we presented logical components (switches, controllers, sliders, etc.) for the first time. These interactive "Logical Components" have their own intelligence as catalog elements, which can be combined to a complex switching logic by using an intuitive logic editor and used for the interactive control of vehicles or vehicle kinematics in the driver mode and in the HTC Vive® mode. This further enhances the practical driving experience in virtual reality. Logical Components are delivered as functionality of the "Analysis Extended Package".

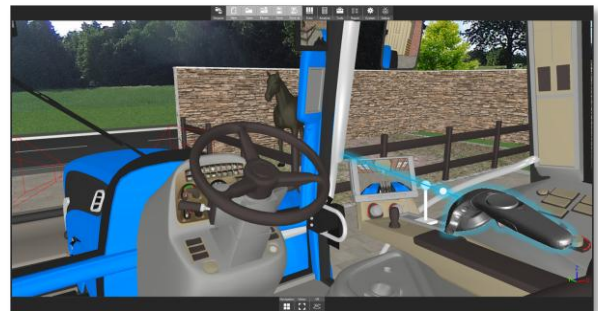

In 2018, the add-on "User-defined Work Lights" will be available. Supported by a wizard, user- or company-specific working lights can be integrated into the **EMM-Check** to extend the catalog. The outstanding feature of this add-on is the functionality to store the working light-specific light distribution, which has to be provided by the manufacturer of the working light as ies-file. An editor supports the correct positioning of the working light geometry in relation to the light distribution.

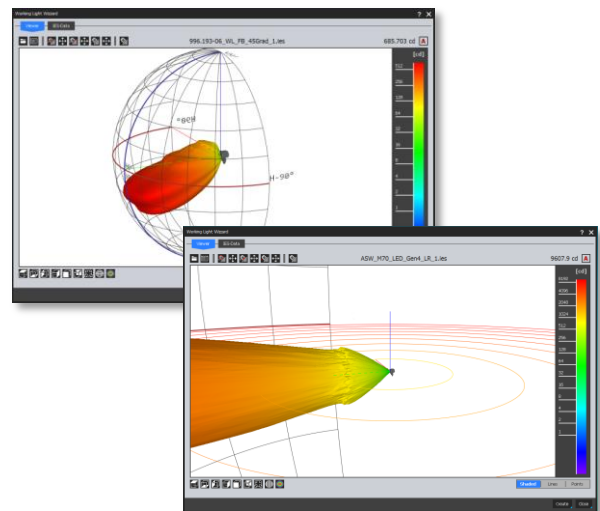

• Last but not least

An eventful year is drawing to a close. We would like to take this opportunity to thank you for your confidence and the pleasant cooperation.

We and our team wish you a Merry Christmas and a healthy and successful New Year 2018.



Dirk JanBen
Managing Director

Sebastian Schneider
Managing Director