

# Panorama

Facts // News // Information

- **Agritechnica 2017**

At the **Agritechnica 2017** we will again provide you with comprehensive information about innovations in **EMM-Check 4**.

The normative visual inspection of virtual agricultural machines is just as much a focus of our live presentations as the experience of virtual reality in a team with the HTC Vive®.



You will find us in **hall 17** at **booth D51** as co-exhibitor of Mekra Lang GmbH & Co. KG.

We look forward to your visit and interesting discussions with you!

- **New Standard „EN 16842“**

The implementation of the standard "EN 16842-1/2" in **EMM-Check** was successfully completed, as announced in the last "**Panorama**".

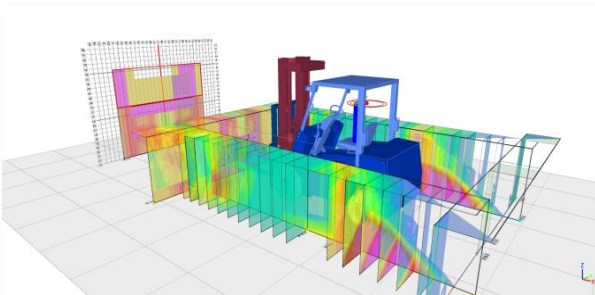

This standard replaces the current field-of-view standard DIN EN 16307 for industrial trucks (forklifts) and is currently available as "Final Draft".

Compared to the standard DIN EN 16307, EN 16842-1/2 defines a more complex test procedure and a different evaluation of the results. In addition to the view of the front face of the test body, its top and side face are also evaluated, depending on the position of the test body in relation to the SIP.

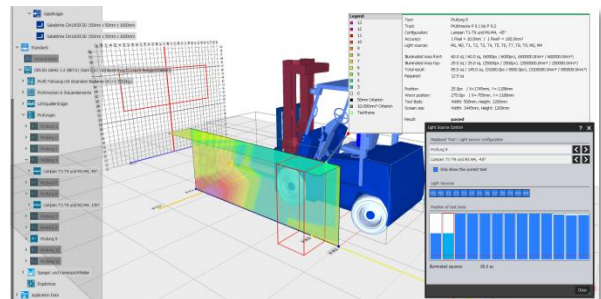

The evaluation of the visibility on the test body and the test screen is done on the basis of visible squares and no longer on a percentage basis.

Due to the large number of test body positions to be evaluated, computer-aided visual field analysis of industrial trucks in accordance with this standard appears to be indispensable.

- **VR-Menu in HTC Vive®**

With Release 4.2.4.0, which was released on 2nd of November 2017, a VR menu is now available in the HTC Vive®.

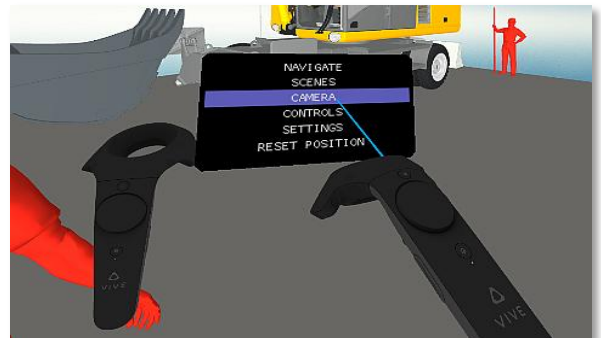

The following new menu functions make navigation in the virtual world much easier.

- **NAVIGATE:** Switching between user-defined VR presets to reach predefined positions (e. g. position of the driver in the cab, behind the vehicle or next to the vehicle).
- **FREE TELEPORTING:** Free navigation in the virtual world. This means that any position in and around a vehicle can be reached no matter how big it is.
- **SCENES:** Switching of environments and/or vehicle configurations defined in scenes.
- **CAMERA:** If cameras have been installed on the vehicle, the camera views can be displayed on the VR menu. The views are updated in real time as the vehicle moves.
- **CONTROLS:** If no gamepad or joystick is to be used to move the vehicle, all defined controls can now also be activated via the VR menu and controlled it with the HTC controllers.
- **SETTINGS:** For FREE TELEPORTING, you can set whether the you want to teleport with a fixed height (position of the eyes) or define the height yourself. Teleporting with a fixed height is useful if you want to walk around the vehicle, for example.
- **RESET POSITION:** Returns the user to the initial position.

Of course the position detection of the HTC Vive® can still be used to walk around within a range of approx. 4m x 4m.

#### • New Add-on "Virtual Reality-Cluster"

As of Release 4.2.4.0, the Add-on "Virtual Reality Cluster" announced at this year's EMM-Check Customer Day in Frankfurt/Main is available.



The Add-on makes it possible to experience the virtual world together! With your colleagues and/or your customers you can experience design reviews, technical discussions or product presentations in Room-Scale-VR. Participants can be physically separated.

For data exchange only an internet connection is required (e. g. VPN tunnel).

#### **Benefits:**

- team-based reviews of analysis results
- team-based design studies and reviews
- team-based product presentations
- subjective visual assessment
- viewing the vehicle in original size

#### **Technical Requirements:**

- EMM-Check 4 (Viewer Package)
- REKNOW VR-Server (free)
- Add-on „Virtual Reality Cluster“
- for using the HTC Vive®:
  - Add-on „HTC Vive®-Integration“
  - HTC Vive®

REKNOW has launched a promotion campaign for the market launch of the **Virtual Reality Cluster** with a **discount of 50%**. The promotion campaign runs from 1st of November to the 31st of December 2017. Please feel free to contact us if you are interested!

Note: We present this Add-on at this year's **Agritechnica** (see also 1. article).

#### • Review 4th EMM-Check Customer Day 2017

The focus of the 4th EMM-Check 4 Customer Day, which took place for the first time this year in Frankfurt/Main, was on the new standard "ISO 5006:2017", the new Add-on "ISO Lux-Rendering" for lighting simulation on vehicle geometry and the topic "Virtual Reality".



Representatives of leading manufacturers of construction machinery and agricultural machinery make use of the opportunities offered by networking and made active use of the possibilities for hand-on's on virtual excavators and tractors.

#### • Information / Contact

Current information about **EMM-Check** you'll find on our website [www.reknow.de/emm-check](http://www.reknow.de/emm-check).

You can call us by dialing the following number  
+49 (0)40 98 76 00 02

or by calling our hotline

0800 735 66 99  
*free from German landline*

You are also welcome to send us an eMail to [info@reknow.de](mailto:info@reknow.de).